

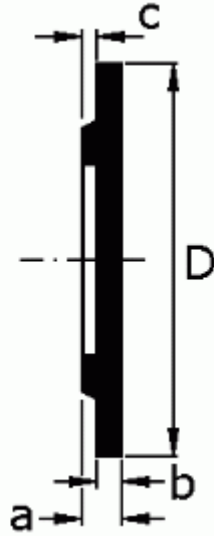

Blank Flange



PN 10

Unit: mm

| DN | D | a | b | c | Weight (kg) |
|------|------|------|------|---|-------------|
| 80 | 200 | 19.0 | 16.0 | 3 | 3.5 |
| 100 | 220 | 19.0 | 16.0 | 3 | 4.3 |
| 150 | 285 | 19.0 | 16.0 | 3 | 7.2 |
| 200 | 340 | 20.0 | 17.0 | 3 | 11.0 |
| 250 | 400 | 22.0 | 19.0 | 3 | 16.9 |
| 300 | 455 | 24.5 | 20.5 | 4 | 24.0 |
| 350 | 505 | 24.5 | 20.5 | 4 | 29.5 |
| 400 | 565 | 24.5 | 20.5 | 4 | 36.5 |
| 450 | 615 | 25.5 | 21.5 | 4 | 46.6 |
| 500 | 670 | 26.5 | 22.5 | 4 | 56.0 |
| 600 | 780 | 30.0 | 25.0 | 5 | 85.0 |
| 700 | 895 | 32.5 | 27.5 | 5 | 123.0 |
| 800 | 1015 | 35.0 | 30.0 | 5 | 172.0 |
| 900 | 1115 | 37.5 | 32.5 | 5 | 224.0 |
| 1000 | 1230 | 40.0 | 35.0 | 5 | 293.0 |
| 1100 | 1340 | 42.5 | 37.5 | 5 | 379.0 |
| 1200 | 1455 | 45.0 | 40.0 | 5 | 575.0 |



■PN 16 SHIN NAN CASTING FACTORY CO., LTD. Unit: mm

| DN | D | a | b | c | Weight (kg) |
|------|------|------|------|---|-------------|
| 80 | 200 | 19.0 | 16.0 | 3 | 3.5 |
| 100 | 220 | 19.0 | 16.0 | 3 | 4.3 |
| 150 | 285 | 19.0 | 16.0 | 3 | 7.2 |
| 200 | 340 | 20.0 | 17.0 | 3 | 10.8 |
| 250 | 400 | 22.0 | 19.0 | 3 | 16.6 |
| 300 | 455 | 24.5 | 20.5 | 4 | 23.5 |
| 350 | 520 | 26.5 | 22.5 | 4 | 33.5 |
| 400 | 580 | 28.0 | 24.0 | 4 | 44.5 |
| 450 | 640 | 30.0 | 26.0 | 4 | 61.0 |
| 500 | 715 | 31.5 | 27.5 | 4 | 77.0 |
| 600 | 840 | 36.0 | 31.0 | 5 | 121.0 |
| 700 | 910 | 39.5 | 34.5 | 5 | 156.0 |
| 800 | 1025 | 43.0 | 38.0 | 5 | 218.0 |
| 900 | 1125 | 46.5 | 41.5 | 5 | 286.0 |
| 1000 | 1255 | 50.0 | 45.0 | 5 | 387.0 |
| 1100 | 1355 | 53.5 | 48.5 | 5 | 501.0 |
| 1200 | 1485 | 57.0 | 52.0 | 5 | 662.0 |

■PN 25 SHIN NAN CASTING FACTORY CO., LTD. Unit: mm

| DN | D | a | b | c | Weight (kg) |
|-----|-----|------|------|---|-------------|
| 80 | 200 | 19.0 | 16.0 | 3 | 3.5 |
| 100 | 235 | 19.0 | 16.0 | 3 | 4.8 |
| 150 | 300 | 20.0 | 17.0 | 3 | 8.3 |
| 200 | 360 | 22.0 | 19.0 | 3 | 13.3 |
| 250 | 425 | 24.5 | 21.5 | 3 | 21.0 |
| 300 | 485 | 27.5 | 23.5 | 4 | 30.0 |
| 350 | 555 | 30.0 | 25.0 | 4 | 43.5 |
| 400 | 620 | 32.0 | 28.0 | 4 | 58.0 |
| 450 | 670 | 34.5 | 30.5 | 4 | 77.8 |
| 500 | 730 | 36.5 | 32.5 | 4 | 94.0 |
| 600 | 845 | 42.0 | 37.0 | 5 | 144.0 |

■PN 40 SHIN NAN CASTING FACTORY CO., LTD. Unit: mm

| DN | D | a | b | c | Weight (kg) |
|-----|-----|------|------|---|-------------|
| 80 | 200 | 19.0 | 16.0 | 3 | 3.7 |
| 100 | 235 | 19.0 | 16.0 | 3 | 5.1 |
| 150 | 300 | 26.0 | 23.0 | 3 | 11.4 |
| 200 | 375 | 30.0 | 27.0 | 3 | 20.0 |
| 250 | 450 | 34.5 | 31.5 | 3 | 34.5 |
| 300 | 515 | 39.5 | 35.5 | 4 | 51.0 |